

INSTALLATION

1. PRECAUTION

CAUTION:

Read "PRECAUTION" thoroughly before servicing (See page RS-1).

2. INSTALL STEERING PAD

(a) Support the steering pad with one hand as shown in the illustration.

(b) Connect the 2 connectors to the steering pad.

NOTICE:

When handling the airbag connector, take care not to damage the airbag wire harness.

(c) Connect the horn connector.

(d) Confirm that the circumferential groove of the "Torx" screw fits in the screw case, and place the steering pad onto the steering wheel assembly.

(e) Using "Torx" socket wrench (T30), tighten the 2 "Torx" screws.

Torque: 8.8 N*m (90 kgf*cm, 78 in.*lbf)

NOTICE:

Tighten the 2 bolts while holding the steering pad to prevent it from moving upward.

3. INSTALL STEERING WHEEL COVER LOWER NO.3

(a) Install steering wheel cover lower No.3.

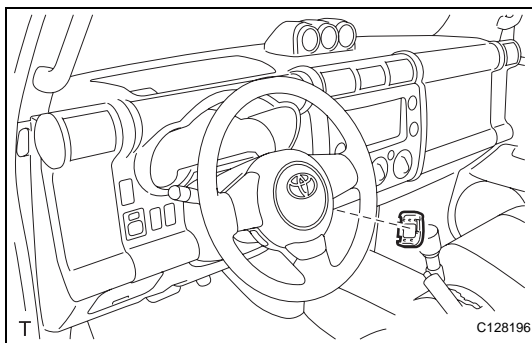
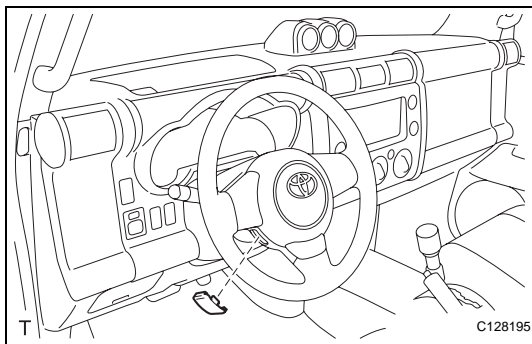
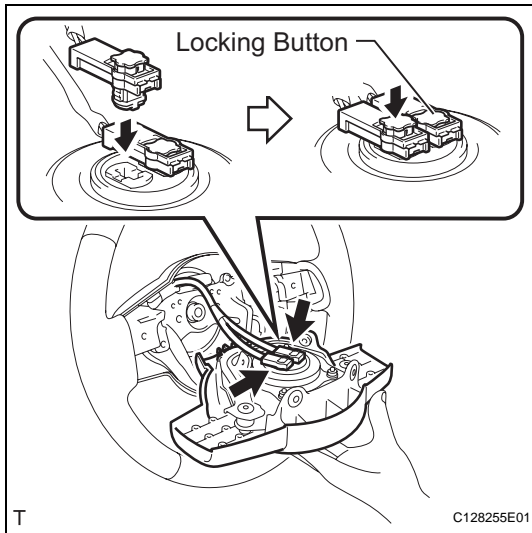

4. INSTALL STEERING WHEEL COVER LOWER NO.2

(a) Install steering wheel cover lower No.2.

5. CONNECT CABLE TO NEGATIVE BATTERY TERMINAL

Torque: 3.9 N*m (40 kgf*cm, 35 in.*lbf)

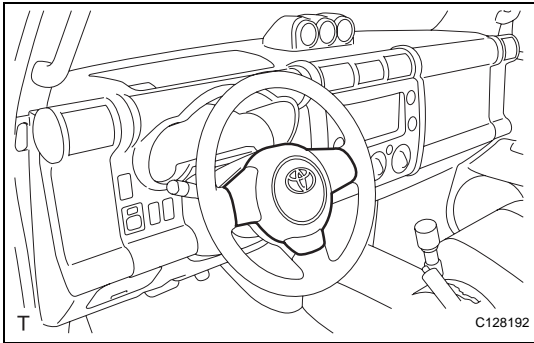
**6. INSPECT STEERING PAD**

- (a) With the steering pad installed on the vehicle, perform a visual check. If there are any defects as mentioned below, replace the steering pad with a new one:
Cuts, minute cracks or marked discoloration on the steering pad top surface or in the grooved portion.
- (b) Make sure that the horn sounds.
HINT:
If the horn does not sound, inspect the horn system (See page [HO-10](#)).

7. PERFORM INITIALIZATION

- (a) Perform initialization (See page [IN-31](#)).
HINT:
Some systems need initialization when the cable has been disconnected from the negative battery terminal.

8. INSPECT SRS WARNING LIGHT

- (a) Inspect the SRS warning light (See page [RS-29](#)).

DISPOSAL

HINT:

When scrapping a vehicle equipped with the SRS or disposing of the steering pad, be sure to deploy the airbag first in accordance with the procedure described below. If any abnormality occurs with the airbag deployment, contact the SERVICE DEPT. of TOYOTA MOTOR SALES, U.S.A., INC.

CAUTION:

- Never dispose of a steering pad that has an undeployed airbag.
- The airbag produces an exploding sound when it is deployed, so perform the operation outdoors and where it will not create a nuisance to nearby residents.
- When deploying the airbag, always use the specified SST (SRS Airbag Deployment Tool). Perform the operation in a place away from electrical noise.
- When deploying the airbag, perform the operation at least 10 m (33 ft) away from the steering pad.
- The steering pad becomes extremely hot when the airbag is deployed, so do not touch it for at least 30 minutes after deployment.
- Use gloves and safety glasses when handling a steering pad with a deployed airbag.
- Do not apply water, etc. to a steering pad with a deployed airbag.
- Always wash your hands with water after completing the operation.

1. DISPOSE OF STEERING PAD (WHEN INSTALLED IN VEHICLE)

HINT:

Prepare a battery as the power source to deploy the airbag.

- (a) Check the function of SST.

SST 09082-00700

CAUTION:

When deploying the airbag, always use the specified SST:

SRS Airbag Deployment Tool

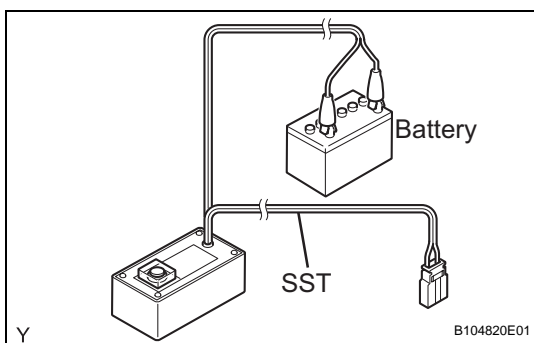
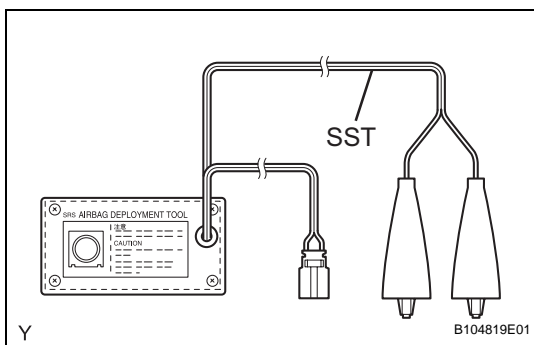

- (1) Connect SST to the battery.
Connect the red clip of SST to the positive (+) battery terminal and the black clip of SST to the negative (-) terminal.

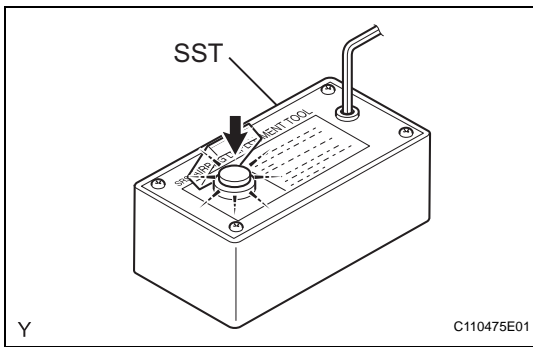

- (2) Check the function of SST.
Press the SST activation switch, and check that the LED of the SST activation switch comes on.

CAUTION:

- Do not connect the SST connector (yellow colored one) to the airbag.
- If the LED comes on when the activation switch is not being pressed, SST may be malfunctioning, so replace SST with a new one.

- (3) Disconnect SST from the battery.

- (b) Precaution (See page RS-1).
(c) Disconnect the cable from the negative battery terminal.

CAUTION:

Wait for at least 90 seconds after disconnecting the cable to prevent the airbag from working.

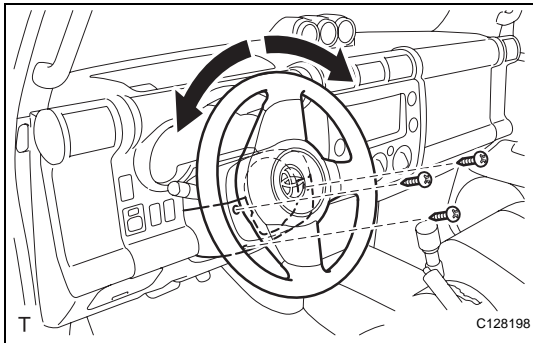

- (d) Remove the lower steering column cover.
(1) While turning the steering wheel assembly to the right and left, remove the 3 screws and the lower steering column cover.

- (e) Install SST.

CAUTION:

Check that there is no looseness in the steering wheel assembly or steering pad.

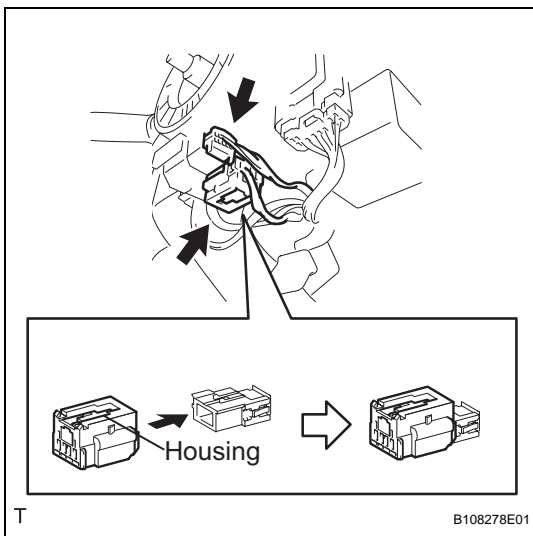

- (1) Disconnect the airbag connector (yellow colored one) from the spiral cable.

NOTICE:

When handling the airbag connector, take care not to damage the airbag wire harness.

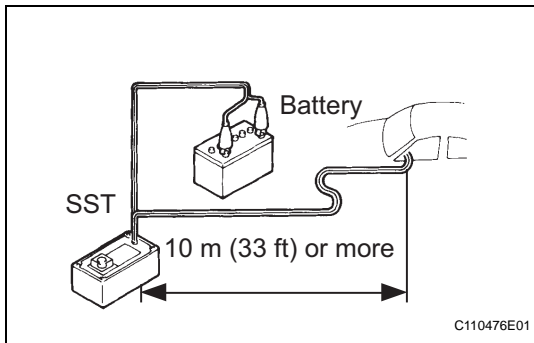
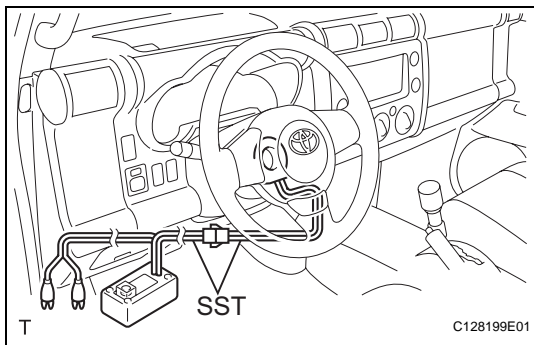

RS

- (2) Connect the SST connector to the airbag connector of the spiral cable.

SST 09082-00700, 09082-00780

NOTICE:

To avoid damaging the SST connector and wire harness, do not lock the secondary lock of the twin lock.

- (3) Move SST at least 10 m (33 ft) away from the vehicle.
 (4) Securing enough clearance for the SST wire harness in the side window, close all doors and windows of the vehicle.

NOTICE:

Take care not to damage the SST wire harness.

- (5) Connect the red clip of SST to the positive (+) battery terminal and the black clip of SST to the negative (-) terminal.
 (f) Deploy the airbag.

- (1) Check that no one is inside the vehicle or within a 10 m (33 ft) radius of the vehicle.

- (2) Press the SST activation switch and deploy the airbag.

CAUTION:

- **When deploying the airbag, make sure that no one is near the vehicle.**
- **The steering pad becomes extremely hot when the airbag is deployed, so do not touch it for at least 30 minutes after deployment.**
- **Use gloves and safety glasses when handling a steering pad with a deployed airbag.**
- **Do not apply water, etc. to a steering pad with a deployed airbag.**
- **Always wash your hands with water after completing the operation.**

HINT:

The airbag is deployed as the LED of the SST activation switch comes on.

2. DISPOSE OF STEERING PAD (WHEN NOT INSTALLED IN VEHICLE)

NOTICE:

- **When disposing of the steering pad, never use the customer's vehicle to deploy the airbag.**
- **Be sure to follow the procedure detailed below when deploying the airbag.**

HINT:

Prepare a battery as the power source to deploy the airbag.

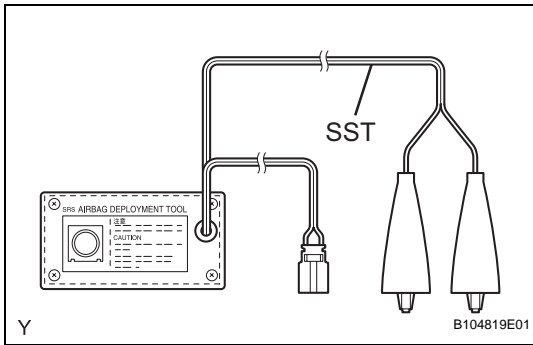

(a) Check the function of SST.

SST 09082-00700

CAUTION:

When deploying the airbag, always use the specified SST:

SRS Airbag Deployment Tool

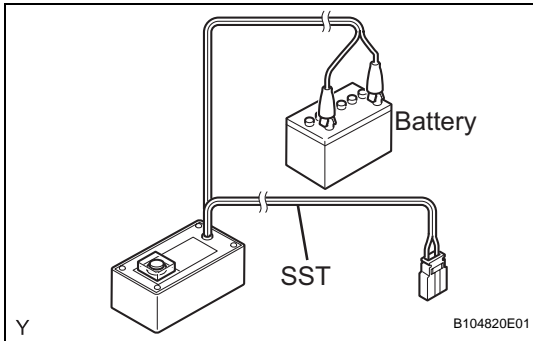

(1) Connect SST to the battery.

Connect the red clip of SST to the positive (+) battery terminal and the black clip of the SST to the negative (-) terminal.

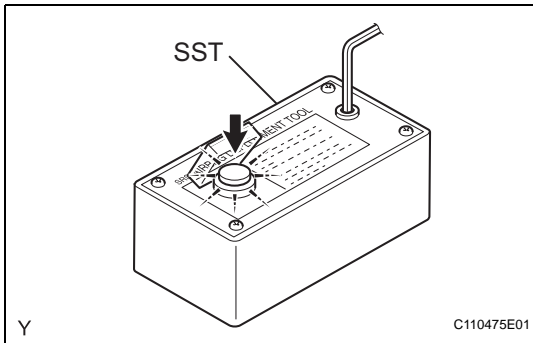

(2) Check the function of SST.

Press the SST activation switch, and check that the LED of the SST activation switch comes on.

CAUTION:

- Do not connect the SST connector (yellow colored one) to the airbag.
- If the LED comes on when the activation switch is not being pressed, SST may be malfunctioning, so replace SST with a new one.

(3) Disconnect SST from the battery.

(b) Remove the steering pad (See page [RS-345](#)).

CAUTION:

- When removing the steering pad, work must be started 90 seconds after the ignition switch is turned to the "LOCK" position and the negative (-) terminal cable is disconnected from the battery.
- When storing the steering pad, keep the airbag deployment side facing upward.

(c) Using a service-purpose wire harness for the vehicle, tie down the steering pad to the disc wheel.

Stripped wire harness section:

Area	Measurement
A	1.25 mm ² or more (0.0019 in. ² or more)

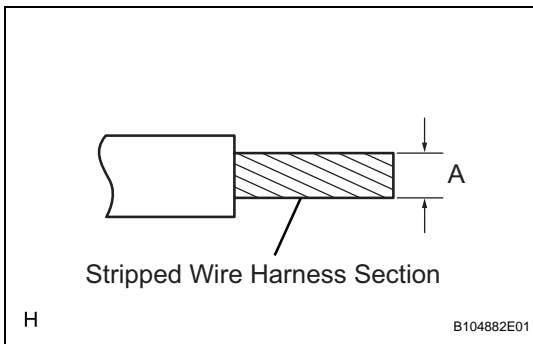

RS

CAUTION:

If the wire harness is too thin or any other object is used to tie down the steering pad, it may be snapped by the shock when the airbag is deployed. Always use a wire harness for vehicle use with a cross section of at least 1.25 mm² (0.0019 in.²).

HINT:

To calculate the area of the stripped wire harness section:

$$\text{Area} = 3.14 \times (\text{Diameter})^2 \text{ divided by } 4$$

- (1) Install the 2 bolts with washers into the 2 bolt holes on the steering pad.

Bolt size:

Area	Specification
L	35.0 mm (1.378 in.)
M	6.0 mm (0.236 in.)
Pitch	1.0 mm (0.039 in.)

NOTICE:

- Tighten the bolts by hand until they become difficult to turn.
 - Do not tighten the bolts excessively.
- (2) After connecting SST below to each other, connect them to the steering pad.

SST 09082-00802 (09082-10801, 09082-30801)

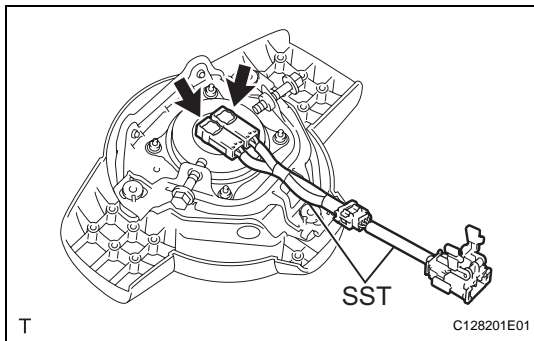
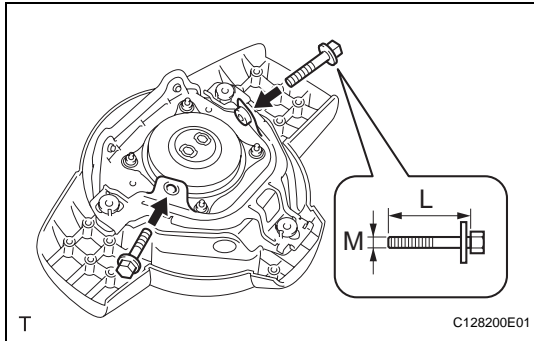

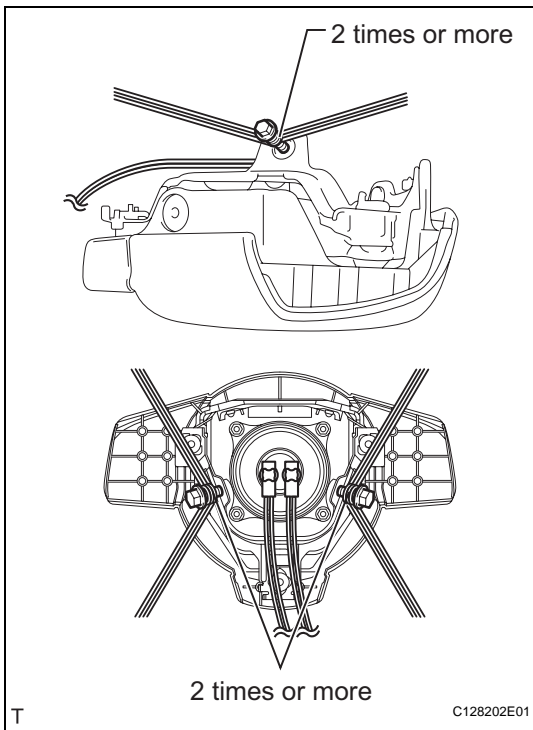

- (3) Using 3 wire harnesses, wind wire harness at least 2 times each around the bolts installed on the left and right sides of the steering pad.

CAUTION:

- Tightly wind the wire harness around the bolts so that there is no slack.
- Make sure that the wire harness is tight. If there is slack in the wire harness, the steering pad may become loose due to the shock when the airbag is deployed.

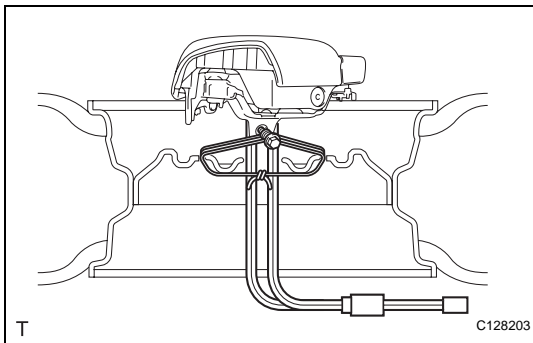

- (4) Face the airbag deployment side of the steering pad upward on top of a tire and wheel set. Separately tie the left and right sides of the steering pad to the disc wheel through the hub nut holes. Position the SST connector so that it hangs downward through the hub hole in the disc wheel.

CAUTION:

- Make sure that the wire harness is tight. If there is slack in the wire harness, the steering pad may become loose due to the shock when the airbag is deployed.
- Always tie down the steering pad with the airbag deployment side facing upward.

NOTICE:

The disc wheel will be damaged by airbag deployment, so use a waste disc wheel.

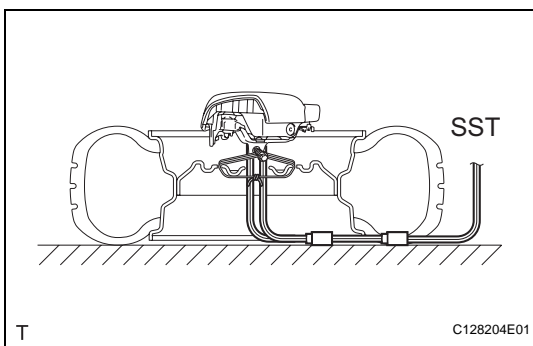

- (d) Install the SST.

CAUTION:

Place the disc wheel on a level ground.

- (1) Connect the SST connector.

SST 09082-00700

NOTICE:

To avoid damaging the SST connector and wire harness, do not lock the secondary lock of the twin lock. Also, secure some slack for the SST wire harness inside the disc wheel.

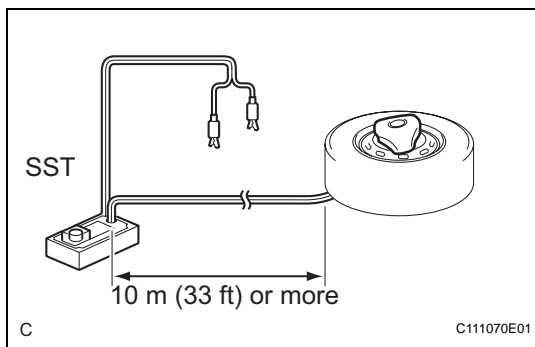

- (2) Move SST at least 10 m (33 ft) away from the airbag tied down to the tire.

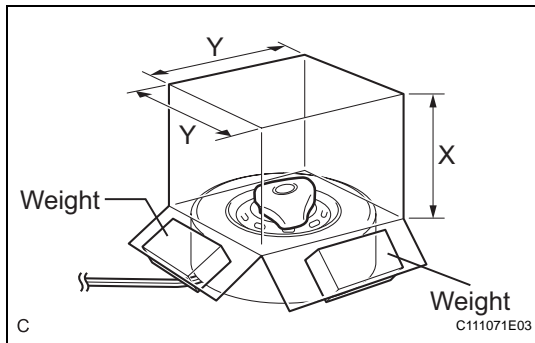

- (e) Cover the steering pad (Using a cardboard box).
- (1) Cover the steering pad with the cardboard box.
 - (2) Place weights of at least 190 N (19 kg, 43 lb) on the cardboard box in 4 places.

Cardboard box size:

Must exceed the following dimensions.

Area	Measurement
X	460 mm (18.11 in.)
Y	650 mm (25.59 in.)

NOTICE:

- When dimension Y of the cardboard box exceeds the diameter of the disc wheel with tire to which the steering pad is tied, X should be the following size.
 $X = 460 \text{ mm (18.11 in.)} + \text{width of tire}$
- If a cardboard box which is smaller than the specified size is used, the cardboard box will be broken by the shock from airbag deployment.

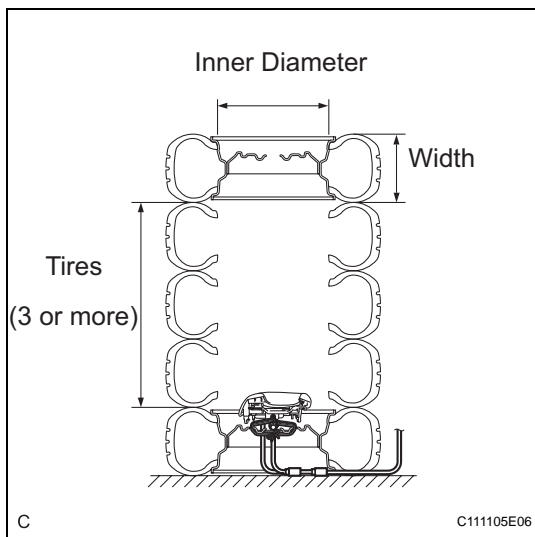

- (f) Cover the steering pad (Using tires).
- (1) Place at least 3 tires without disc wheels on the tire with disc wheel to which the steering pad is tied.
 - (2) Place the tire with a disc wheel on top of them.

Tire size:

Must exceed the following dimensions.

Area	Measurement
Width	185 mm (7.28 in.)
Inner diameter	360 mm (14.17 in.)

CAUTION:

Do not use tires with disc wheels except for those on the top and bottom.

NOTICE:

- The tires may be damaged by the airbag deployment, so use waste tires.
- Do not place the SST connector under the tire because it could be damaged.

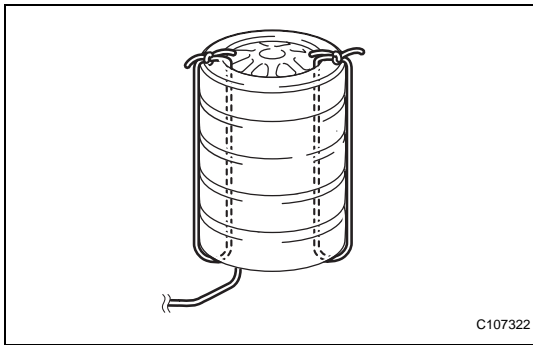

- (3) Tie the tires together with 2 wire harnesses.
CAUTION:
Make sure that the wire harnesses are tight. Looseness in the wire harnesses results in the tires coming free due to the shock when the airbag is deployed.

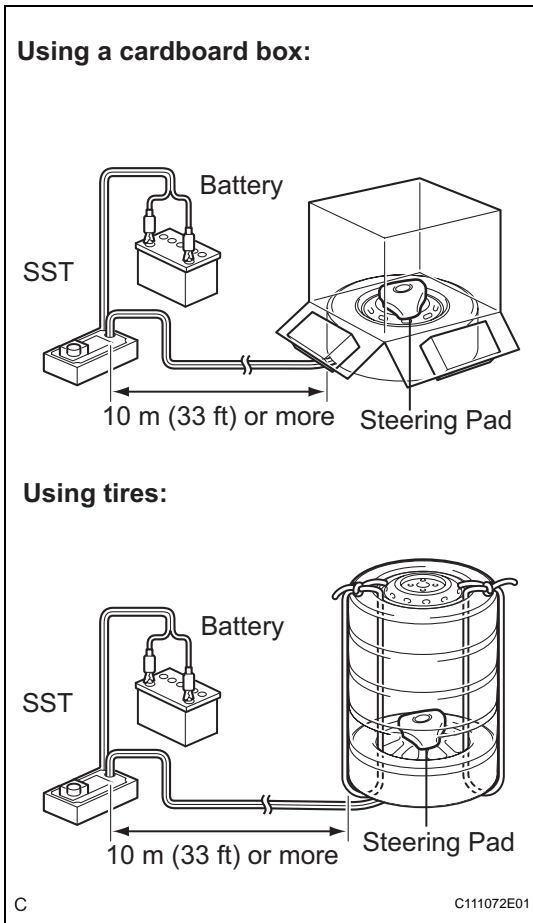

- (g) Deploy the airbag.
- (1) Connect the red clip of SST to the positive (+) battery terminal and the black clip of the SST to the negative (-) terminal.
 - (2) Check that no one is within a 10 m (33 ft) radius of the disc wheel to which the steering pad is tied.
 - (3) Press the SST activation switch and deploy the airbag.
- CAUTION:**
Make sure that no one is near the tire when deploying the airbag.
- HINT:**
 The airbag is deployed as the LED of the SST activation switch comes on.



- (h) Dispose of the steering pad.
- CAUTION:**
- **The steering pad becomes extremely hot when the airbag is deployed, so do not touch it for at least 30 minutes after deployment.**
 - **Use gloves and safety glasses when handling a steering pad with a deployed airbag.**
 - **Do not apply water, etc. to a steering pad with a deployed airbag.**
 - **Always wash your hands with water after completing the operation.**
- (1) Remove the steering pad from the disc wheel.
 - (2) Place the steering pad in a plastic bag, tie it tightly and dispose of it in the same way as other general parts.